



PAPER FOX COLLECTIVE

MULTI-SERVICE DESIGN FIRM

SPECIALIZING IN RESIDENTIAL MODELING, ENGINEERING AND DOCUMENTATION

Scott McGehee, P.E.

PAPER FOX COLLECTIVE IS LED BY SCOTT MCGEHEE, A LICENSED PROFESSIONAL ENGINEER (VT, CO, MI, NC, MD) WITH A PASSION FOR HOME DESIGN. UPON COMPLETION OF HIS MASTERS OF SCIENCE FOR STRUCTURAL ENGINEERING, HE REMAINED IN THE ENGINEERING PROFESSION FOR SIX YEARS UNTIL BEING GIVEN THE OPPORTUNITY TO WORK AS AN APPRENTICE RESIDENTIAL DESIGNER. THROUGH THE COMBINATION OF HIS KNOWLEDGE AND EXPERIENCE IN THE FIELDS OF DESIGN AND ENGINEERING, SCOTT IS ABLE TO PROVIDE A PRACTICAL AND EFFECTIVE RESIDENTIAL SOLUTION.

PAPER FOX COLLECTIVE SERVICES THE WESTERN NORTH CAROLINA REGION WITH A DIVERSE SELECTION OF RESIDENTIAL SERVICES THAT TRANSFORM VACANT PROPERTIES INTO UNIQUELY DESIGNED HOUSES.

Services Provided



- **SITE STUDY**
RESEARCH & DESIGN PREPARATION



- **RESIDENTIAL DESIGN**
PROPERTY SPECIFIC SOLUTIONS



- **ENGINEERING**
CIVIL & STRUCTURAL SOLUTIONS



- **3D RENDERING**
PHOTO REALISTIC IMAGES & VIDEOS



- **SITE DOCUMENTATION**
PHOTOGRAPHY & VIDEOGRAPHY

How the Integration of Engineering Impacts Design

AVOID OPEN SPACE

DIRECTLY BELOW THE MAIN ROOF RIDGE TO ELIMINATE THE NEED FOR A BEAM TO CATCH A ROOF BRACE.

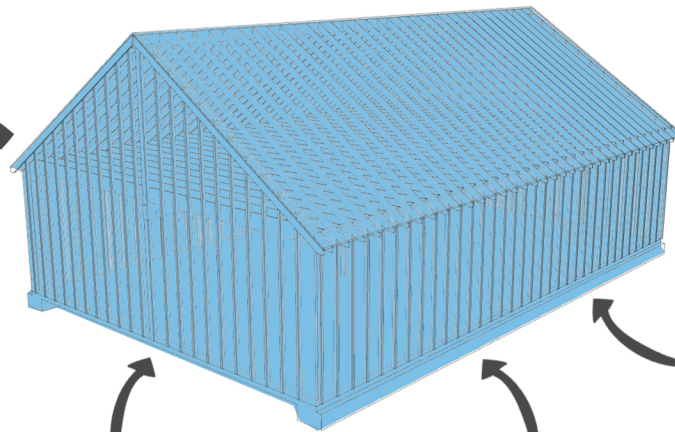
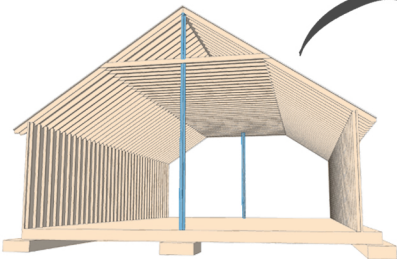

COLUMN GRID PATTERNS

CAN ELIMINATE UNNECESSARY BEAMS BY ALLOWING A WALL TO TERMINATE INTO EACH STUD PACK.

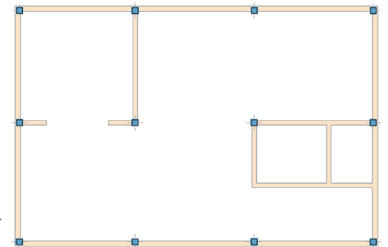

LARGE OPENINGS

SHOULD EXIST IN NON-LOAD BEARING WALLS TO ELIMINATE THE NEED FOR STRUCTURAL HEADER MEMBERS.

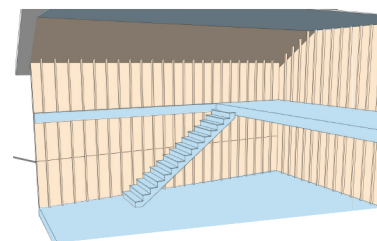
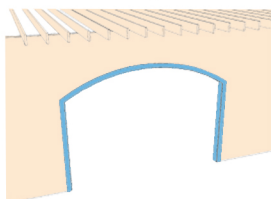

SPLIT LEVELS

CAN PROVIDE AN ADDITIONAL FLOOR FOR HOUSES DESIGNED WITH A CRAWL SPACE BY TAKING ADVANTAGE OF UNUSED ATTIC SPACE.

Communication